

ITP Soft Type Backer Rod

Joint Forming, Pliable, Non-gassing,
Polyethylene Foam Backer Rod

TECHNICAL DATA FORM 104

Basic Use

ITP Soft Type Backer Rod is a soft, grey, pliable, non-gassing backup material inserted into an expansion or contraction joint to:

- Control sealant depth
- Create a backstop to allow proper sealant tooling
- Ensure sealant adhesion to joint surfaces only
- And yield a proper bond break between backup material and sealant

It can also be used as a temporary joint seal.

Specific Uses

Particularly suited for specialty applications where standard backer rods are not appropriate. Ideal in irregular joint applications particularly where self-leveling, flowable sealants are employed. Also recommended with sealants where bubbling concerns are critical. May also be used in place of most standard backer rod applications. (See Illustration below)

Compatibility

ITP Soft Type Backer Rod is virtually an inert composition and therefore compatible with all known cold applied sealants including butyl, polysulfide, acrylic, polyurethane and silicone.

Composition & Material

ITP Soft Type Backer Rod is a polyethylene foam consisting of both open and closed cells on the inside with a skin-like outer texture. It is highly flexible, pliable and compressible for easy installation. This material is available in a wide variety of diameters.

Table 1 : Stock Sizes Available

Diameter	Shipping Format	Feet per Carton	Metric Diameter	Meters per Carton
*3/8"	1 Spools	2100	9mm	640
5/8"	2 Spools	1550	15mm	472
7/8"	1 Spool	850	22mm	259
1 1/8"	1 Spool	500	29mm	152
1 1/2"	6' Lengths	396	38mm	121
2"	6' Lengths	228	50mm	70
2 1/2"	6' Lengths	144	63mm	44
3"	6' Lengths	102	76mm	31
4"	6' Lengths	48	101mm	15

*Baby Backer Rod Carton—Minimum 2 carton purchase

- Rectangular cartons are ideal for warehousing and handling
- All cartons have convenient hand holes for carrying ease
- UPS and most other package express services will accept all cartons for reshipment
- Truckload quantities furnished on pallets and may be warehoused two pallets high to maximize space.

IRREGULAR EXPANSION JOINT WALLS

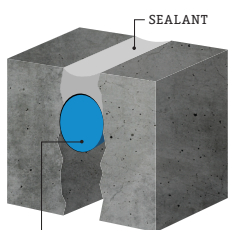

ITP SOFT TYPE BACKER ROD

VIEW VARYING WIDTH JOINT CUT

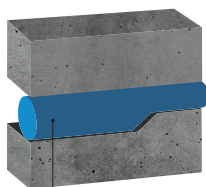

ITP SOFT TYPE BACKER ROD

STANDARD BACKER ROD APPLICATIONS

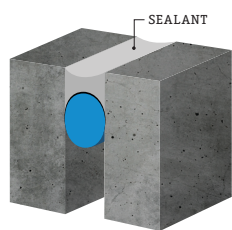

EXPANSION JOINTS

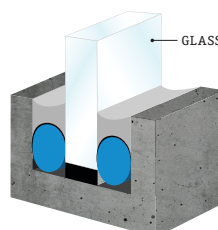

GLAZING



Technical Data

ITP Soft Type Backer Rod is chemically inert and will resist oil, Gasoline and most other solvents. This material will not stain nor adhere to sealant materials and is non-exuding. (Refer to Table 2 for typical physical properties)

ITP Soft Type Backer Rod meets or exceeds the requirements of ASTM-C-1330 Type B.

Installation

Joint or opening must be clean, dry and free of obstructions. Using Table 3 select proper rod diameter and cut to length or use directly from spool. With a blunt instrument or roller, uniformly

install rod at the level recommended by the sealant manufacturer, specifier or architect involved. Generally, the depth of the joint after the backer rod is installed is one half the width. Very large or very small joints vary in terms of this depth to width ratio. Avoid puncturing, stretching or over compression.

Purchasing & Pricing

ITP Soft Type Backer Rod is widely available throughout the United States and Canada. Please contact Industrial Thermo Polymers Limited for the name and address of your local distributor. This source will provide you with samples and pricing information as required.

Technical Assistance

Industrial Thermo Polymers Limited has qualified representatives available to assist users of the various Backer Rod materials referenced herein. Please contact your local ITP distributor should assistance be required.

Purchasing Advantage

ITP offers the widest product range of any North American manufacturer (see Table 4). For prompt delivery, top service and convenient one-stop shopping for all your Backer Rod needs contact ITP or your local ITP distributor today.

Table 2 : Physical Property Analysis

Property	Value	Test Method
Density (nominal)	2 lbs/cu.ft	ASTM-D-1622
Tensile Strength	50 PSI minimum	ASTM-D-1623
Compression Deflection @50%	5 PSI maximum	ASTM-D-1621
Water Absorption	0.05 gm/cc	² ASTM-C-1016
Compression Recovery @50%	95% minimum	ITP
Out-Gassing	None	ASTM-C 1253
Temperature Range	-90°F to 210°F	—
Classification	Type 3	ASTM-D-5249-92

²Determination of water absorption by sealant (joint filter) materials." Prior to ASTM-C-509 standard applicable to gasket and sealing. Material no longer appropriate in evaluating "sealant (joint filter) materials."

Table 4 : Carton Sizes & Weights

Rod Diameter	Weight / Carton	Carton Measurement
3/8" 9mm	6 lbs 2.7 kgs	18" x 18" x 15" 458mm x 458mm x 381mm
5/8" to 1/8" 15mm to 29mm	11 lbs 5.0 kgs	18" x 18" x 30" 458mm x 458mm x 762mm
1 1/2" to 4" 38mm to 101mm	14lbs 6.4 kgs	17" x 10" x 74" 432mm x 254mm x 1880mm

GUARANTEE / WARRANTY

Industrial Thermo Polymers Limited believes the information and recommendations herein to be accurate and reliable and the products are reasonably fit for the applications mentioned. However, as uses, conditions and application methods are not within our control, ITP does not guarantee nor warrant these products nor results from the use of these products or information given. It is therefore the responsibility of the buyer to determine the suitability of these products in applications intended and determine the appropriateness of the products. Sizes and Lengths per spool are those at times of packaging and may vary with climatic conditions after manufacture.

*REGISTERED TRADEMARKS OF INDUSTRIAL THERMO POLYMERS LTD.

Table 3 : Soft Type Backer Rod Size to Joint Width

Joint Width	Diameter
3/16" – 1/4"	3/8"
3/8" – 1/2"	5/8"
1/2" – 3/4"	7/8"
3/4" – 7/8"	1 – 1/8"
7/8" – 1 1/4"	1 1/2"
1 1/4" – 1 1/2"	2"
1 1/2" – 2"	2 1/2"
2" – 2 1/2"	3"
2 1/2" – 3"	4"

As with all Soft Type Backer Rods, diameter should be approximately 25% larger than joint width.

Other ITP Backup Materials also Available

Standard Closed Cell Polyethylene Foam Backer Rod Sizes 1/4" to 6"

Tundra Foam Open Cell in black & yellow Sizes 3/8" to 2"

Hot Rod XL (Hot Pour) Closed Cell Backer Rod Sizes 3/8" to 2"

Polybags Standard & Soft Type Backer Rod

Pony Packs Spool-less boxes of Standard & Soft Type Backer Rods

Also Available from Industrial Thermo Polymers

Pipe Insulation | Noodles (water toys) | Custom Profiles

Industrial Thermo Polymers Limited
 153 Van Kirk Drive, Brampton, Ontario L7A 1A4
 Tel: 905.846.3666 Fax: 905.846.0363 Toll Free: 1.800.387.3847
 Email: info@tundrafoam.com Web: www.tundrafoam.com

